

Undercounters

Side Mounted Condensing Unit - ET & ETG Series

Reference Model: ETR2

The Undercounter Side Mount series comes with the multi-functional advantages of the back mount line with added features to enhance user experience. It comes with a robust digital display and control system for precise temperature management.

● Exterior ○ Interior

1: Digital Control

Multi-function with easy to read LED display.



2: Recessed Door Handle*

Heavy duty with high traction surface.

3: Pre-Installed Door Locks*

Provides security options for any situation.

4: Heavy Duty Swivel Casters

Standard 5" with locks on front set. Optional 3" swivel caster or height-adjustable leg replacements also available.



Blizzard R290 Condensing Unit*

Side mounted, self-contained, fully detachable and uses environmentally friendly, EPA-compliant R290 refrigerant with zero (0) Ozone Depletion Potential (ODP) and three (3) Global Warming Potential (GWP). Blizzard R290 is easily replaceable and requires no on-site brazing.

Audible Overheat Protection Alarm

Keeps compressor and condenser coil from overheating.

Self-Maintaining Condensate Pan

Energy efficient and requires no external drains or electric heaters.

ECM Evaporator Fan Motor

Electronically Commutated. Achieves rapid cooling with less energy.

ECM Condenser Fan Motor

Reversible and Electronically Commutated. Cools down compressor and supports condenser coil cleaning.

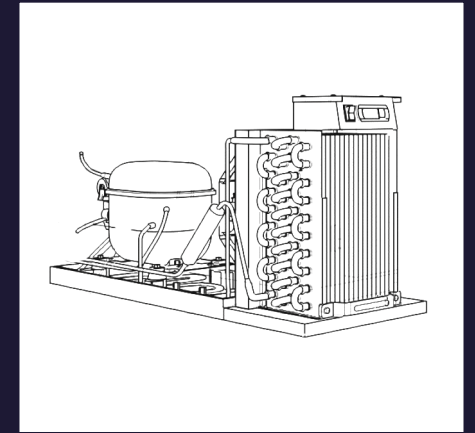

5: Full Length Air Duct

Ensures optimal distribution of cold air.

6: Rear Bumpers

Keeps a safe distance between the wall and the unit to prevent ventilation obstruction.

7: Optional Backsplash

Protects from messy spills on the worktop.

8: Vacuum Relief U-Trap

Keeps hot air from entering the cabinet interior and helps relieve cabinet pressure.

9: Ridge-Lined Door Gaskets

Keeps air tight seal and promotes smooth cabinet re-entry. Snap-in for easy cleaning and replacement.

10: Stainless Steel Interior & Exterior

High quality with rounded corners for a hazard-free workspace.

11: Air Tight Seal

Self-closing door with adjustable torsion system ensures a positive seal.

12: Shatter-Proof LED Lighting*

Silicone coated and energy efficient. Provides bright, high color illumination with low heat output.

13: Thick Insulation

2.5" thick high density polyurethane insulation ensures temperature stability and conserves energy.

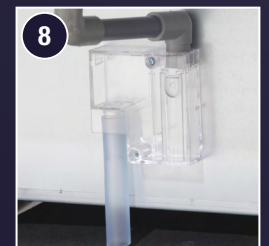
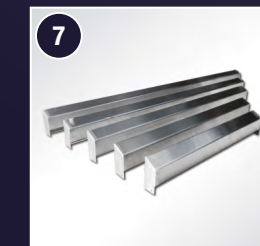
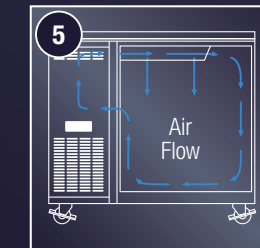

* Applies to select models.